

MLS#26-285

ENGEL & VÖLKERS[®]
SNELL REAL ESTATE

Or Boutique Residences

Price: \$650,000 USD | 13,000,000 MXN



Beds: 2

Baths: 2

Sqft: 2,238.08

Type: Condos

Lot Size: 2238.08

View: OR Cabo Boutique Residences

Community: El Tezal-East

Subdivision: OR Cabo Boutique Residences

Email: info@snellrealestate.com

Office (MX): +52 624-105-8100

Toll Free (US): +1 713-832-1035

OVERVIEW

2 bedroom unit with private rooftop. OR is an award-winning, architect-designed residential project in the Cabo Corridor by Jacobo Micha (Archetonic), recipient of the BLT Built Design Award (2025). With only 25 residences, it offers a rare boutique living experience defined by privacy, quiet luxury, and architectural distinction. The fan-inspired design maximizes orientation, natural light, and views of the desert and sea, using pigmented concrete and natural materials that echo the Baja landscape. Interiors feature generous ceiling heights, elongated living areas, seamless indoor-outdoor flow, and fully equipped modern kitchens. Amenities include a semi-Olympic pool, gym and yoga area with views, games room, fire pits, storages, gated security, and a common rooftop with iconic Arch view

PROPERTY FEATURES

- Property Name: Or Boutique Residences
- Unit #: B402
- Zone: Cabo Corridor
- Area: CSL Cor-Inland
- Community: El Tezal-East
- Subdivision: OR Cabo Boutique Residences
- Construction: Completed
- Price (USD): 650,000
- Seller Financing Offered?: No
- Total M2: 208
- Total SqFt: 2,238.08
- AC M2: 101.48
- AC SqFt: 1,091.92
- Primary View: Ocean
- Year Built: 2,025
- Decks/Patios M2: 106.50
- Secondary View: Arch
- Decks/Patios SqFt: 1,145.94
- Stories: 4
- Total Bedrooms: 2
- Full Baths: 2
- 1/2 Bath: 2
- Furnished: Unfurnished
- Style: Multiple Levels
- Floor Number: 4
- # Units in Develop: 25
- Garage Stalls: 2 cars
- Parking on Property: 2 spaces
- Dishwasher
- Freezer
- Microwave
- Oven: Electric
- Range: Electric
- Refrigerator/Freezer
- Cook Top
- Air Conditioning: Central
- Pool
- Security Guard
- Elevator
- Fence
- Fire Pit
- Garden
- Gym
- Picnic Area

GALLERY

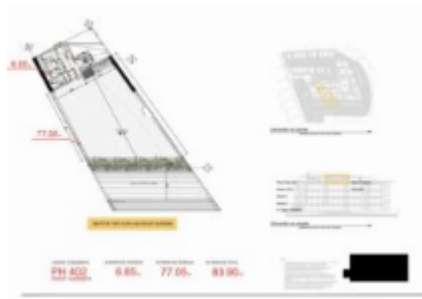



LOCATION

